

Step 1: Logging in to the Destiny Quest mobile app

- Download and install Destiny Quest mobile from the App store or Google Play.
- Launch the Destiny Quest mobile app.
- Enter your Destiny URL and tap **Connect**:

`http://fisd-destiny.fairfield.k12.tx.us`

- Select your school library.
- Enter your User ID and Password.

User Name: `firstname.lastname`

Password: `student ID`

- Tap **Log In**.

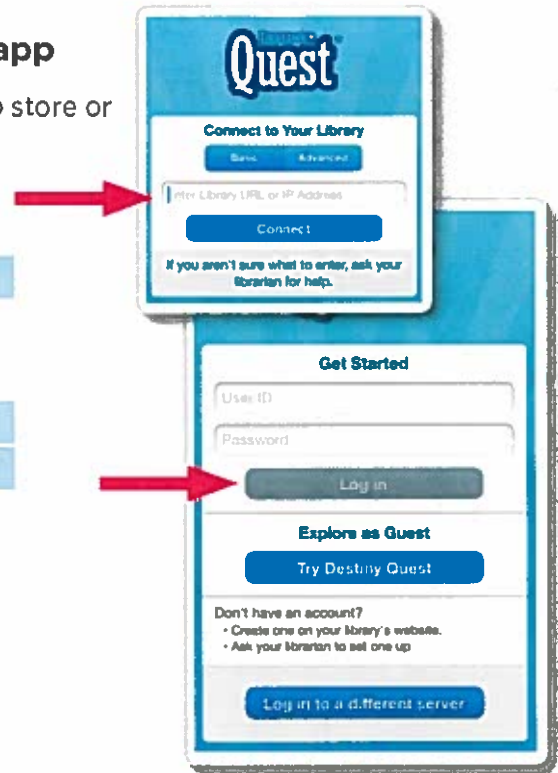

Step 2: Logging in to the BryteWave™ K-12 Edition app

- Download and install the BryteWave K-12 Edition app from the App store or Google Play.
- Launch the mobile app.
- Enter your **User Name** and **Password**.

User Name: `firstname.lastname`

Password: `student ID`

- Enter the Follett Shelf URL:

`http://wbb49778.follettshelf.com`

- If you are on a private/safe/secure device and want to skip steps C and D next time you access the mobile app, select the **Stay logged in** checkbox.

- Tap **Log In**.

Note: BryteWave K-12 Edition is a new app and not an update to previous Follett Reader apps. If you are currently using the Follett Digital Reader app, please uninstall it and download the new BryteWave K-12 Edition app.

